

# Equestrian Land, Horse Pasture, Paddock, Barn

\$ 69,900

📍 Kissimmee, Florida

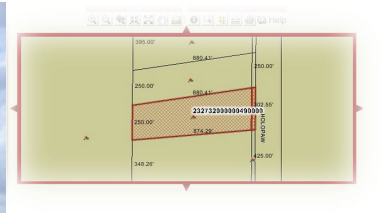

Private

407-846-

2787x112

- Land ▪ 5+ Acres ▪ Kissimmee, FL 34741

## Description

5+ acres that offers country living and city convenience. This property is ready for your horse friends! It has a pond, paddock, is fenced & cross-fenced and already has a two stall barn. Well and electric is already on the property. Zoning allows for a site built home or mobile home. Located on the eastern side of St. Cloud, Fl. it is far enough from the crowds yet only about a 15 minute drive to shopping and restaurants. If you love the ocean you are about a 40 minute drive east to Melbourne Beach. If you are more of a theme park enthusiast, Disney World, Universal and Sea World are approximately a 40 minute drive west. People flock to Florida for our year 'round summer weather and the fact we have no state income tax and our property taxes are very reasonable. Please call me with any questions you might have, or to view the property. It doesn't cost a thing to look!

To see this ad online, go to [www.horseclicks.com](http://www.horseclicks.com) and search for **HT24780A4**

**Category** Properties

**Subcategory** Land

**Status** Available

**Lot Size** 5+ Acres

**County** Osceola

**Country** United States of America

**Location** Kissimmee, FL 34741

Features

## Features

Pond  
Pasture  
Fenced  
Horse Barn

## Images



917 Emmett St. Kissimmee, FL. 34741

**Goodwin Realty & Associates, Inc.**



**Jo Ann Cumbie**  
Broker-Associate  
Cell: 407-973-8270  
Office: 407-846-2787  
Cumbie@cfl.rr.com

All information is believed to be true, but is not guaranteed.

Directions to 5424 Holopaw Rd.  
Take 192 east  
Go past Harmony to the flashing light  
Turn right on Holopaw Rd. (Hwy 441) The sign is on the property.

